

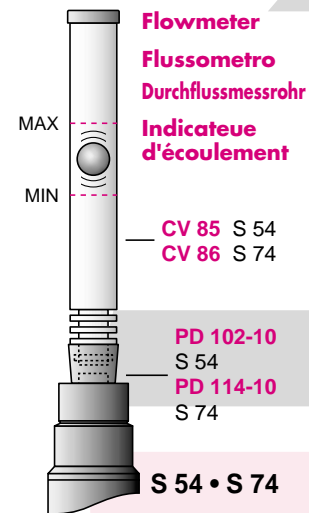

PACKAGING

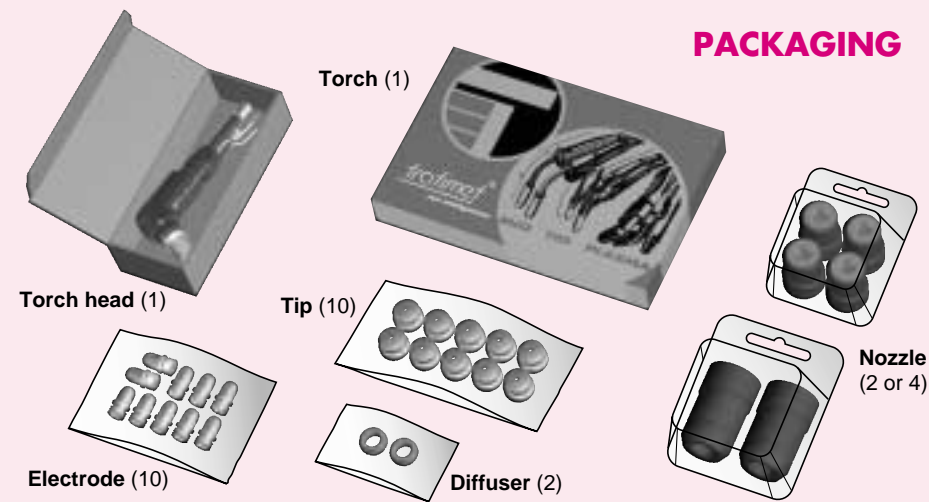

Warning

For proper use and maintenance refer to the user's handbook attached to the torch.

Attenzione

Consultare il manuale di uso e manutenzione allegato alla torcia.

Achtung

Bitte unbedingt das beigefügte Bedienungshandbuch beachten.

Attention

Consultez le manuel d'utilisation et de manutention joint à la torche.

Operating instructions

The excessive wear of tip and electrode may cause some damage to the torch head. Replace the electrode before its total consumption as well as the tip when showing an irregular hole or an increased diameter.

Modalità d'uso

L'eccessiva usura di cappa ed elettrodo può creare danni al corpo torcia, sostituire l'elettrodo prima del totale consumo dell'inserto e la cappa quando presenta un foro irregolare o di diametro maggiorato.

Gebrauchsanweisung

Elektrode und Schneiddüsen sollten auf den Verschleiß hin überprüft werden, überhöhte Beanspruchung führt zu verschlechterten Schneidergebnissen und kann zu einer Beschädigung des Brennerkörpers führen.

Modalite d'usage

L'usure excessive de la tuyère et de l'électrode peuvent causer des dommages au col de cygne, remplacer l'électrode avant l'usure totale de l'insert en HF ainsi que la tuyère si celle-ci présente une "usure irrégulière" ou un diamètre majoré.

Check the state of the swirl ring. Air holes must be open. If not, the low cooling system will damage the torch head.

Controllare lo stato di efficienza del diffusore aria, che deve sempre presentare i fori di accesso aria liberi da occlusioni.

Überprüfen des Luftverteilers, das die Löcher nicht verstopft sind.

Contrôler le rendement du diffuseur d'air dont les trous d'accès d'air doivent rester libres de toutes occlusions.

Warranty will be valid only for genuine TRAFIMET spare parts

La garanzia viene riconosciuta soltanto per ricambi originali TRAFIMET

Garantie wird nur für Original TRAFIMET Teile übernommen

Utiliser seulement pièces d'usure originales TRAFIMET

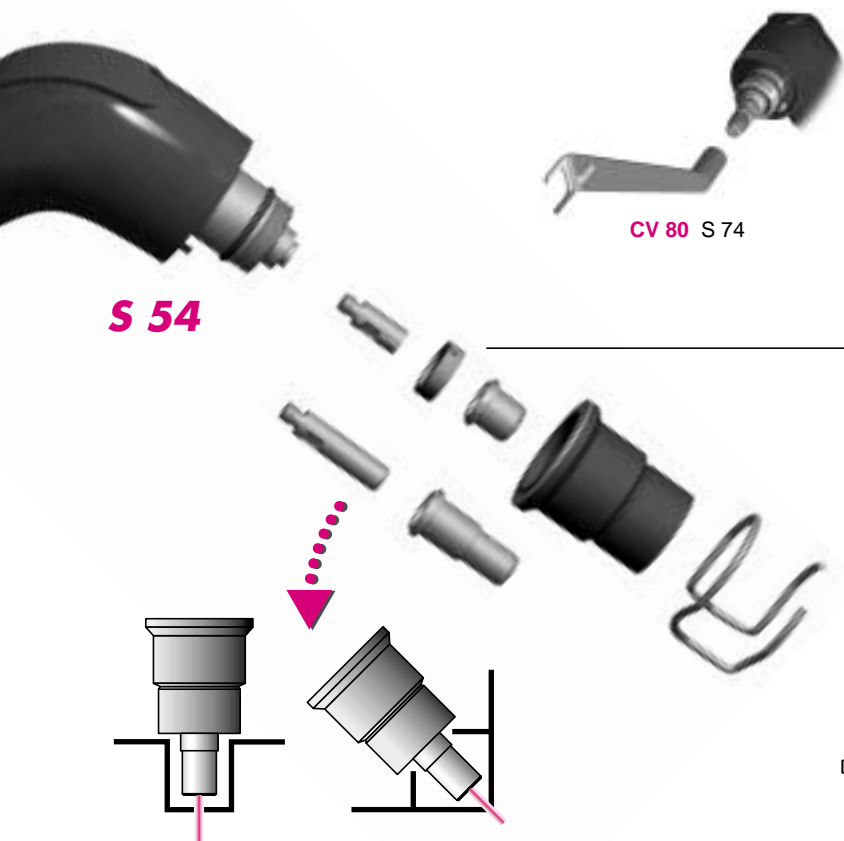

S 54

CV 80 S 74

S 54

S 74

S 54 S 74

PLASMA TORCHES



trafimet®

your welding partner

TRAFIMET spa claim that all items on this catalogue are manufactured in conformity with the "low voltage" CE 73/23 directive as per EN 50078 and EN 50192 standards. The company reserve the right to modify any products without notice. TRAFIMET spa is the registered owner of all trademarks, patents and models.

Copyright © February 1997 • by TRAFIMET spa (Print 05/98) EA 0529

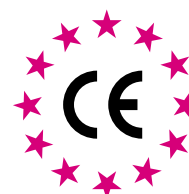

EN 50078
EN 50192

trafimet®

your welding partner

Torches with pilot arc without HF
Torce con arco pilota senza alta frequenza
Brenner mit Pilotzündung,
keine Hochfrequenz-Zündung
Torches avec arc pilote sans HF

S 54

Patented by Trafimet

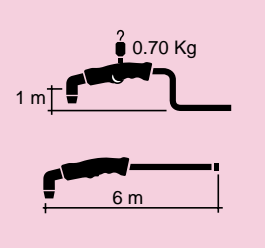

Technical data S 54

Voltage class	M
Standard length	6 m
Air consumption	100 l/min
Air pressure	4.5-5 bar
Duty cycle 100%	40 A
Duty cycle 60%	50 A

Technical data S 74

Voltage class	M
Standard length	6 m
Air consumption	150 l/min
Air pressure	5-5.5 bar
Duty cycle 100%	50 A
Duty cycle 60%	70 A

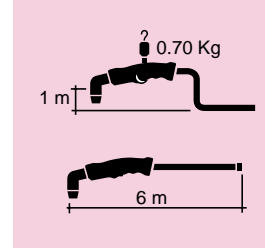

S 74

Patented by Trafimet

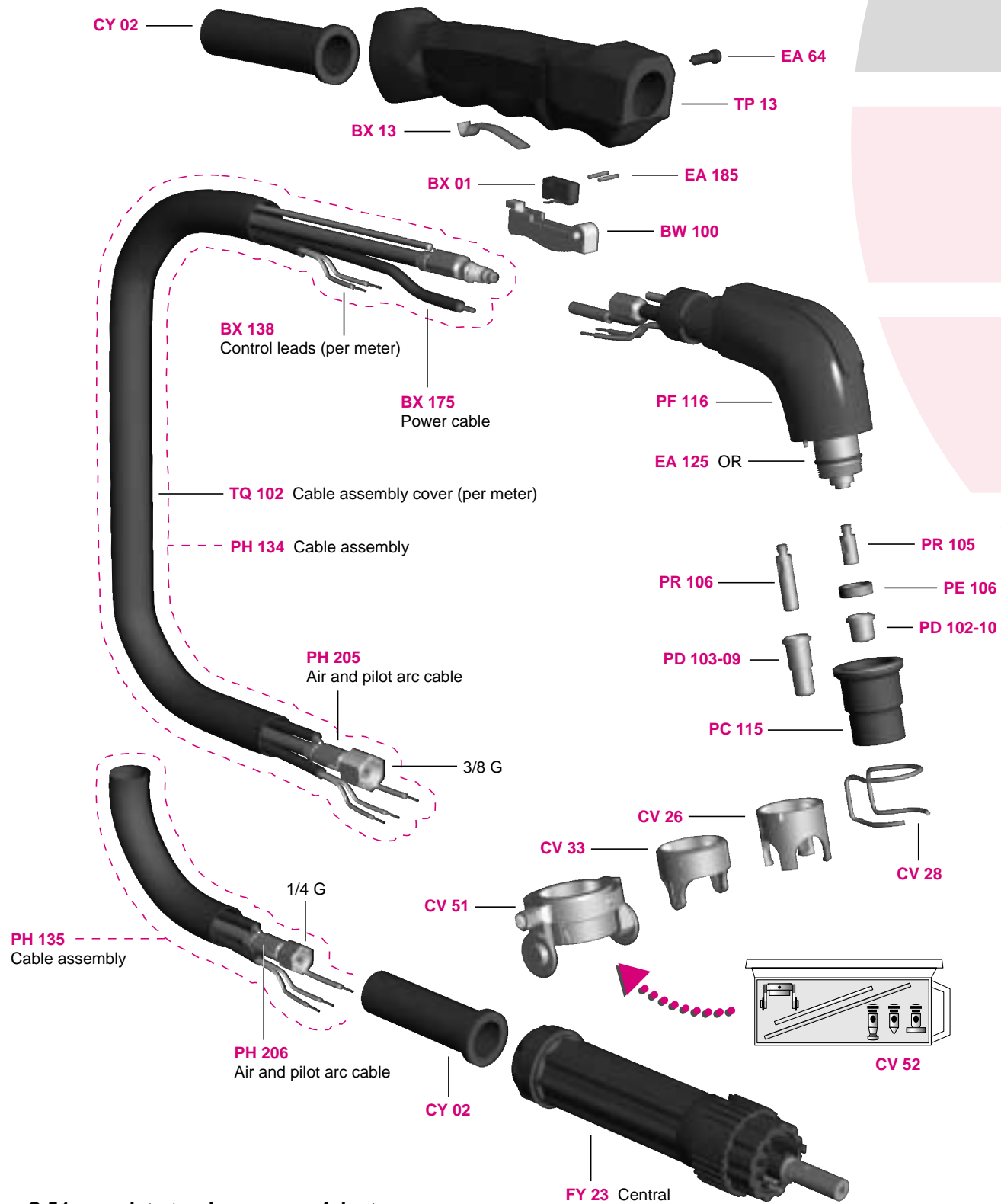

S 54 complete torch	m	Adaptor
PA 150	6	3/8 G
PA 151	6	Central
PA 155	6	1/4 G

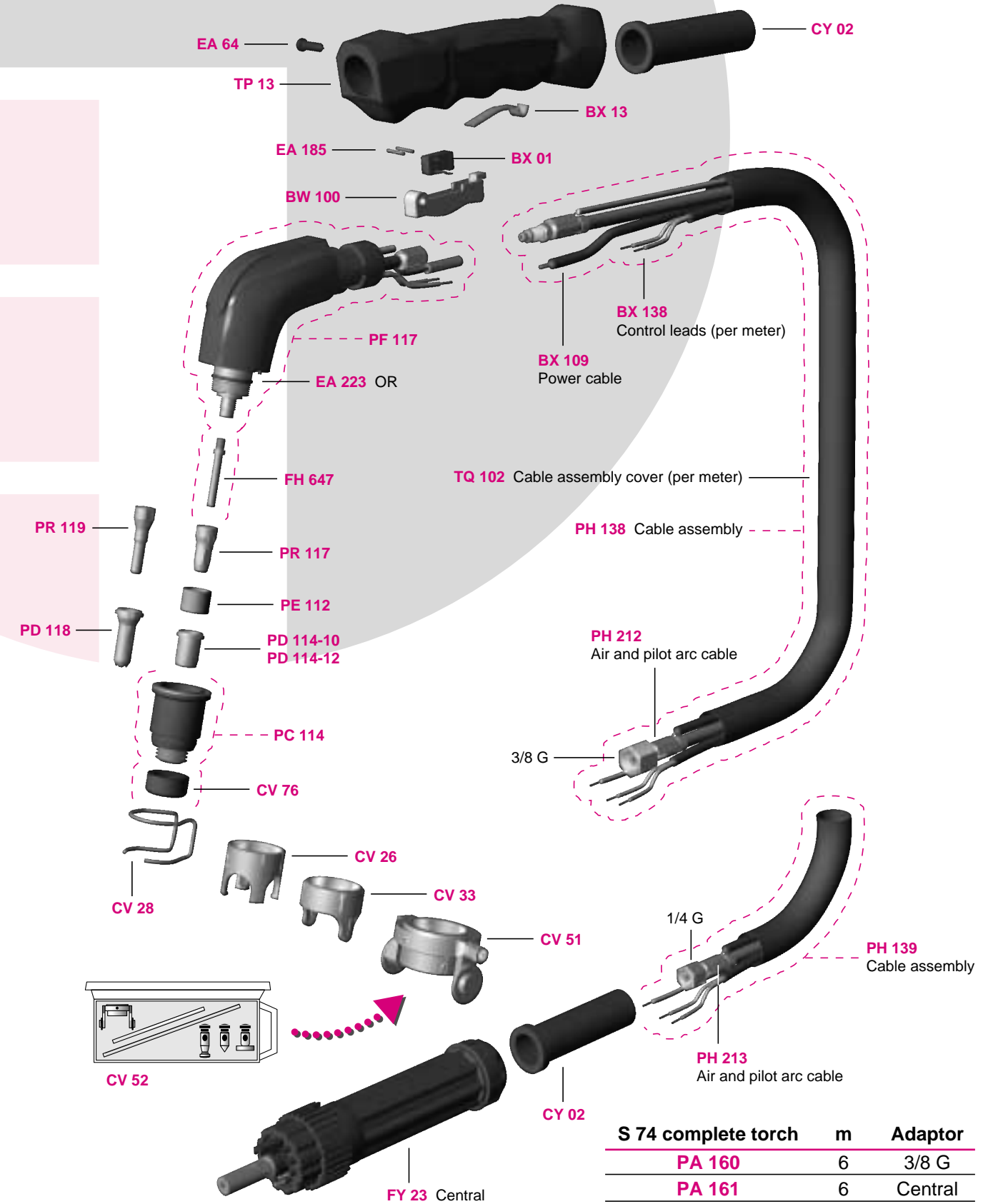

S 74 complete torch	m	Adaptor
PA 160	6	3/8 G
PA 161	6	Central
PA 163	6	1/4 G